

## Speed switch P2-10



### Application

Turning fan on/off and speed switching for multi-speed fans.

### Design and control

The speed switch casing is made of non-combustible and impact-resistant ABS plastic. The switch has an integrated on/off button and a speed switch button.

### Mounting

The speed switch is designed for indoor installation and flush wall mounting inside a junction box and its fixation with screws or fixing lugs. A junction box and fasteners are not included in the delivery set.

### Technical data:

Max. power voltage [V]	250
Max. load current [A]	10
Cable cross section [mm <sup>2</sup> ]	from 0.35 up to 0.75
Temperature range [°C]	from -10 up to +45
Humidity range [%]	5 - 80 (no condensation)
Service life	1 000 000 switching operations
Protection rating	IP40
Weight [kg]	0.098

### Overall dimensions [mm]:

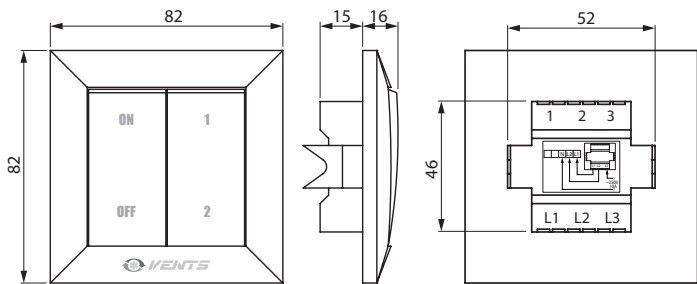

### Wiring diagram:

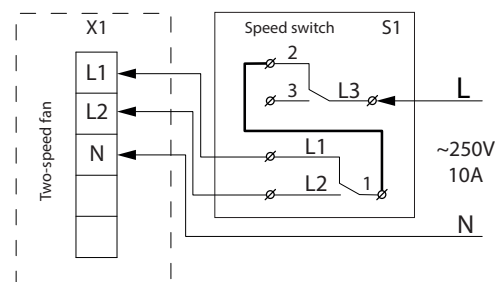

### Speed switch control:

Control: switch buttons for turning on/off and speed changeover.

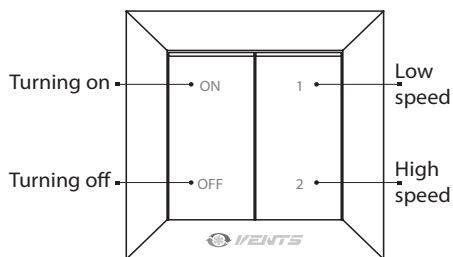

### JUNCTION BOX

