



EN

AXIAL FAN
User's manual

Quiet-Hex

 **VENTS**

www.ventilation-system.com

CONTENTS

Delivery set.....	7
Brief description	7
Operation guidelines	7
Designation key.....	8
Installation.....	10
Fan setup	12
Connection to power mains	13
Maintenance.....	22
Troubleshooting.....	23
Storage and transportation regulations.....	23
Manufacturer's warranty	24

This user's manual is a main operating document intended for technical, maintenance, and operating staff.

The manual contains information about purpose, technical details, operating principle, design, and installation of the Quiet-Hex unit and all its modifications.

Technical and maintenance staff must have theoretical and practical training in the field of ventilation systems and should be able to work in accordance with workplace safety rules as well as construction norms and standards applicable in the territory of the country.



**READ THE USER'S MANUAL CAREFULLY BEFORE PROCEEDING WITH INSTALLATION WORKS.
COMPLIANCE WITH THE MANUAL REQUIREMENTS ENSURES RELIABLE OPERATION AND LONG
SERVICE LIFE OF THE UNIT. KEEP THE USER'S MANUAL AVAILABLE AS LONG AS YOU USE THE UNIT.
YOU MAY NEED TO REREAD THE INFORMATION ON THE PRODUCT SERVICING.**

This unit is not intended for use by persons (including children) with reduced physical, sensory or mental capabilities, or lack of experience and knowledge, unless they have been given supervision or instruction concerning use of the unit by a person responsible for their safety.

Children should be supervised to ensure that they do not play with the unit.

This appliance can be used by children aged from 8 years and above and persons with reduced physical, sensory or mental capabilities or lack of experience and knowledge if they have been given supervision or instruction concerning use of the appliance in a safe way and understand the hazards involved.

Cleaning and user maintenance shall not be done by children without supervision.

Children shall not play with the appliance.

Precautions must be taken to avoid the back-flow of gases into the room from the open flue of gas or other fuel-burning appliances.

The appliance may adversely affect the safe operation of appliances burning gas or other fuels (including those in other rooms) due to back flow of combustion gases. These gases can potentially result in carbon monoxide poisoning. After installation of the unit the operation of flued gas appliances should be tested by a competent person to ensure that back flow of combustion gases does not occur.

Connection to the mains must be made through a disconnecting device, which is integrated into the fixed wiring system in accordance with the wiring rules for design of electrical units, and has a contact separation in all poles that allows for full disconnection under overvoltage category III conditions.

Ensure that the unit is switched off from the supply mains before removing the guard.

All operations described in this manual must be performed by qualified personnel only, properly trained and qualified to install, make electrical connections and maintain ventilation units.

Do not attempt to install the product, connect it to the mains, or perform maintenance yourself.

This is unsafe and impossible without special knowledge.

Disconnect the power supply prior to any operations with the unit.

All user's manual requirements as well as the provisions of all the applicable local and national construction, electrical, and technical norms and standards must be observed when installing and operating the unit.

Disconnect the unit from the power supply prior to any connection, servicing, maintenance, and repair operations.

Connection of the unit to power mains is allowed by a qualified electrician with a work permit for the electric units up to 1000 V after careful reading of the present user's manual.

Check the unit for any visible damage of the impeller, the casing, and the grille before starting installation. The casing internals must be free of any foreign objects that can damage the impeller blades.

While mounting the unit, avoid compression of the casing! Deformation of the casing may result in motor jam and excessive noise.

Misuse of the unit and any unauthorised modifications are not allowed.

Do not expose the unit to adverse atmospheric agents (rain, sun, etc.).

Transported air must not contain any dust or other solid impurities, sticky substances, or fibrous materials.

Do not use the unit in a hazardous or explosive environment containing spirits, gasoline, insecticides, etc.

Do not close or block the intake or extract vents in order to ensure the efficient air flow.

Do not sit on the unit and do not put objects on it.

The information in this user's manual was correct at the time of the document's preparation.

The Company reserves the right to modify the technical characteristics, design, or configuration of its products at any time in order to incorporate the latest technological developments.

Never touch the unit with wet or damp hands.

Never touch the unit when barefoot.

BEFORE INSTALLING ADDITIONAL EXTERNAL DEVICES, READ THE RELEVANT USER MANUALS.

DELIVERY SET

Fan — 1 pc.

Screws and dowels — 4 pcs.

Plastic screwdriver (only for the models with a timer) — 1 pcs.

User's manual — 1 pc.

Packing box — 1 pc.

Sealing gasket — 1 pc.

BRIEF DESCRIPTION

The unit is an axial fan for extract ventilation of small- and medium-sized residential premises.

The fan is designed for connection to \varnothing 100 mm air ducts.

The fan design is constantly being improved, thus some models may be slightly different from those described in this manual.

OPERATION GUIDELINES

The fan is rated for connection to single-phase AC power mains.

The power mains parameters are specified on the package and/or the label located on the unit casing.

The ingress protection rating against access to hazardous parts and water ingress is IP45.

WARNING! The ingress protection rating is specified for the mounted unit.

The fan is rated for operation at the ambient temperature ranging from +1 °C up to +40 °C.

WARNING! Do not operate the fan beyond the specified temperature range.

The unit is rated as a Class II electrical appliance (220-240 V, 50/60 Hz). The fan does not require grounding.



**THE PRODUCT MUST BE DISPOSED SEPARATELY AT THE END OF ITS SERVICE LIFE.
DO NOT DISPOSE THE UNIT AS UNSORTED DOMESTIC WASTE.**

DESIGNATION KEY

Quiet-Hex 100 Duo T

Accessories

- V – pull cord switch
- T – turn-on delay timer
- T1 – turn-on and turn-off delay timer
- VT – pull cord switch and turn-off delay timer
- TH – humidity sensor and turn-off delay timer
- VTH – pull cord switch and humidity sensor
- TR – motion sensor

Motor modifications

- _ – single-speed motor
- Duo – two-speed motor

Outlet duct diameter [mm]

Fan series

The products can be installed in zones according to the table below, provided that the installation and connection are performed in accordance with the requirements of IEC 60364-7-701 (current edition), as well as in accordance with the requirements of the national standards of the country of installation.

Quiet-Hex, Quiet-Hex ... T, Quiet-Hex ... TH, Quiet-Hex ... TP	1 2 3
Quiet-Hex ... B, Quiet-Hex ... BT, Quiet-Hex ... VTH	2 3

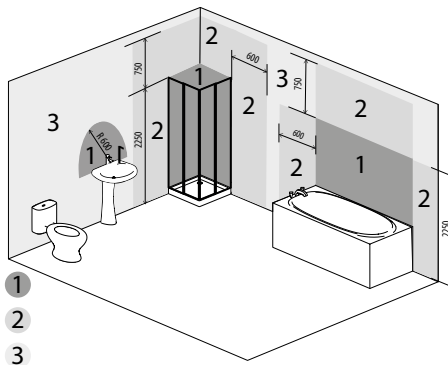

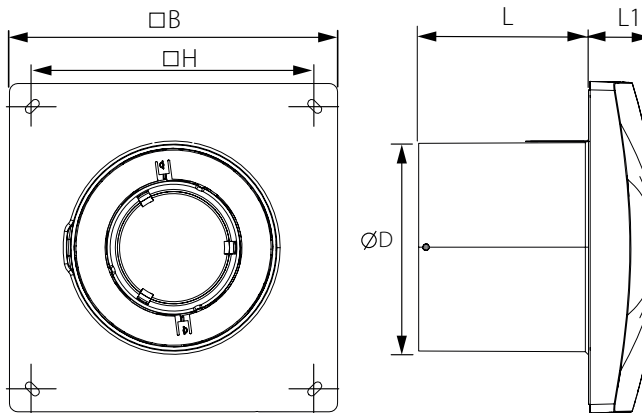

	Dimensions [mm]				
	$\varnothing D$	B	H	L	L1
Quiet-Hex 100	100	158	136	81	26

INSTALLATION

The fan is designed for wall or ceiling mounting with direct air exhaust to the ventilation shaft or into the round air duct of matching diameter.

Fan installation with direct air discharge upwards is not allowed.

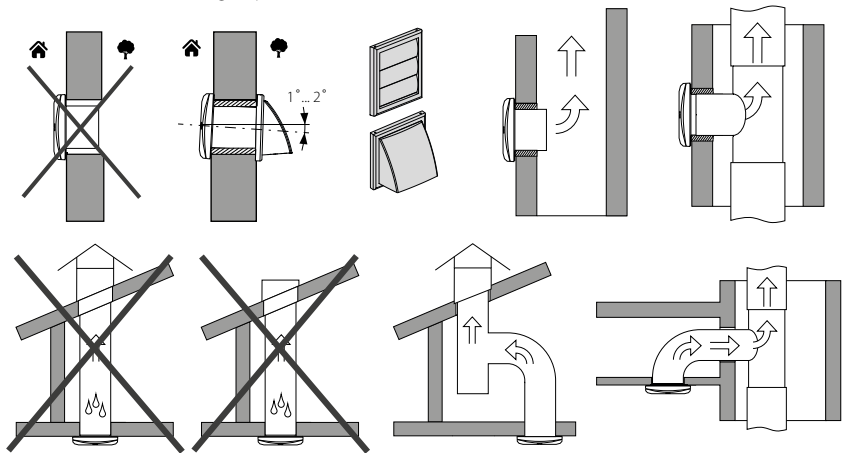

The fan mounting sequence is as follows:

Cut off power supply and make sure electricity has been turned off.

Pull the power cable to the ventilation hole.

Remove the front cover of the fan. Then remove the circuit board cover.

Mark and drill holes for mounting the fan, secure the insulating gasket, install the fan.

Connect the fan to power mains according to the wiring diagram.

Reinstall the circuit board cover and the front panel onto the fan's casing.

Power the fan on.

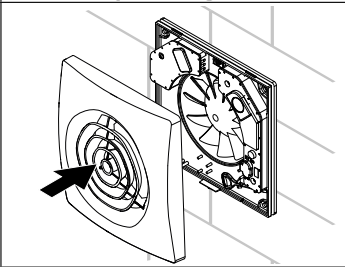
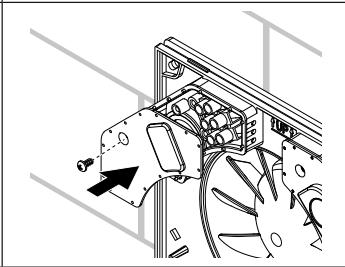
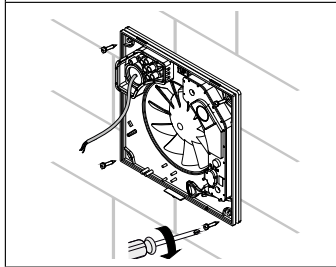
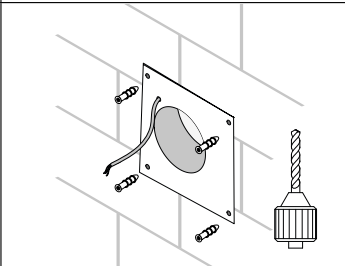
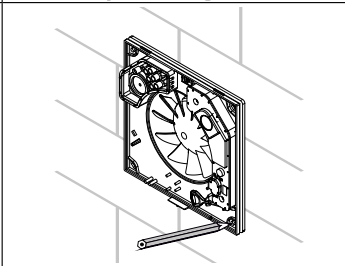
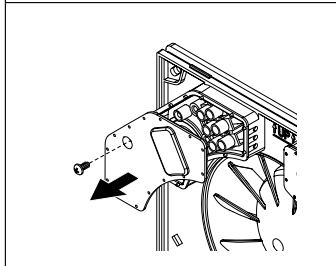
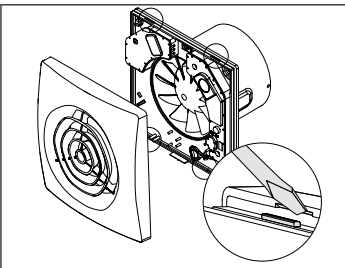
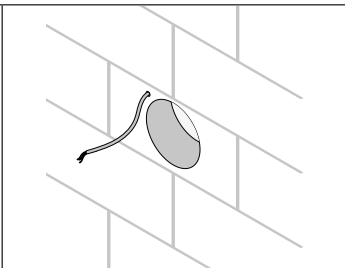
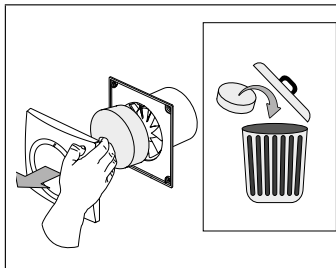

FAN SETUP





**THE TIMER BOARD IS UNDER MAINS VOLTAGE.
MAKE SURE THE FAN IS COMPLETELY DISCONNECTED FROM THE POWER MAINS BEFORE
ADJUSTING**

 T_i — use the potentiometer T_i to enable and adjust the interval timer T_i .

To disable the interval timer, set the T_i potentiometer to the leftmost position.

When the potentiometer is turned 1/3 clockwise, the interval time will be 6 hours, when it is turned 2/3 clockwise, it will be 12 hours, and when it is turned to the rightmost clockwise position, it will be 24 hours.

 T_{on} — To adjust the fan turn-on delay time, turn the control knob T_{on} clockwise to increase and counter-clockwise to decrease the turn-on delay time respectively (from 0 up to 2 minutes).

 T_{off} — To adjust the fan turn-off delay time, turn the control knob T_{off} clockwise to increase and counter-clockwise to decrease the turn-off delay time respectively (from 2 up to 30 minutes).

 H — To adjust the humidity set point turn the control knob H clockwise to increase and counter-clockwise to decrease the humidity sensor set point, adjustable from 60 % up to 90 %.

The fan delivery set includes a specially designed plastic screwdriver for fan settings adjustments. Use it to change the turnon and turn-off delay time and the humidity set point.



**DO NOT USE A METAL SCREWDRIVER, KNIFE, ETC. FOR ADJUSTMENT
OPERATIONS NOT TO DAMAGE THE CIRCUIT BOARD**

CONNECTION TO POWER MAINS

The fan mounting sequence and the wiring diagrams are shown below.

Terminal designations on wiring diagrams

- L — phase;
- N — neutral;
- S — timer control line;

WARNING! The power supply cables must only be routed in the location provided by the manufacturer. Any unauthorized insertion of the power supply cables into an unauthorized opening voids the manufacturer's liability for the product and voids the warranty. The power supply wire must be stripped of insulation by a maximum of 8 mm.

After installation, the user's manual must be turned over to the receiving operator.

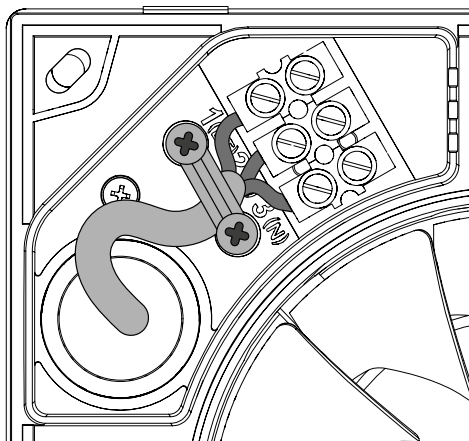

Quiet-Hex 100

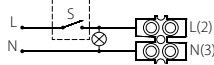
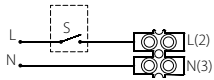

Quiet-Hex 100 V

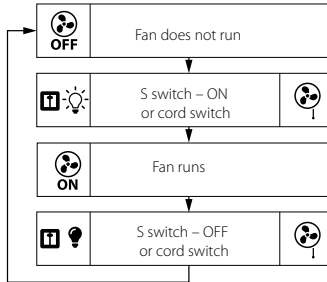
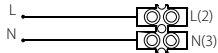

Quiet-Hex 100 T/T1

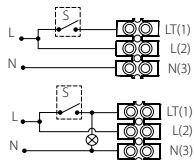

Quiet-Hex 100 VT

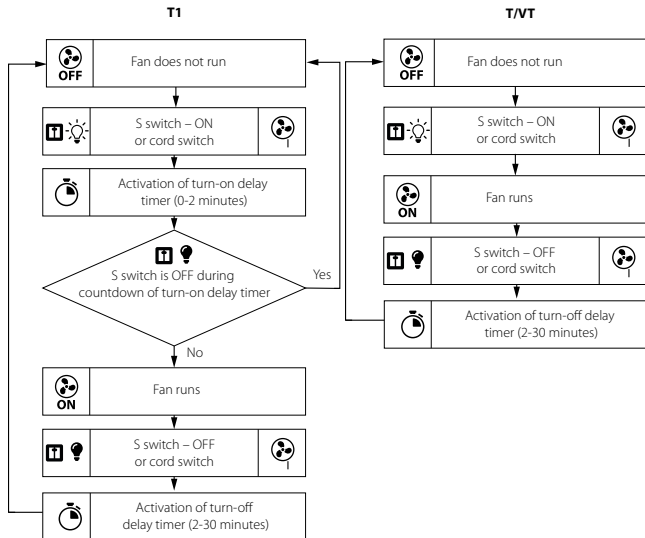
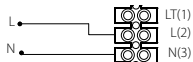

Quiet-Hex 100 TH

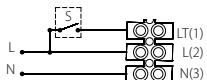

Quiet-Hex 100 VTH

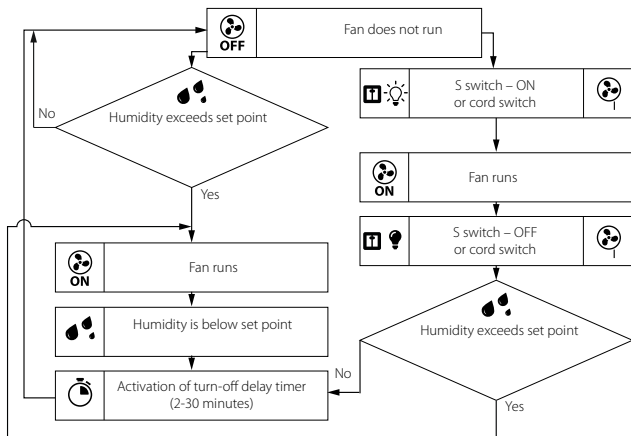
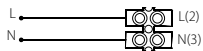

Quiet-Hex 100 TR

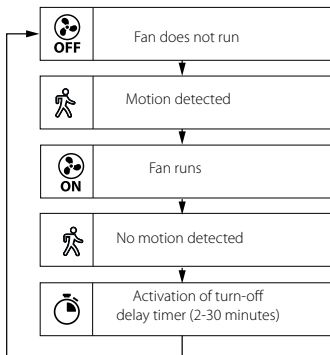
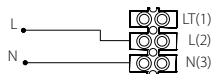

Quiet-Hex 100 Duo (1 speed)

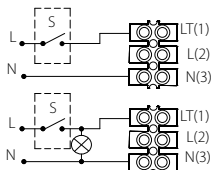

Quiet-Hex 100 Duo V (1 speed)

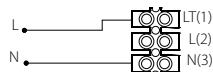

Quiet-Hex 100 Duo (2 speed)

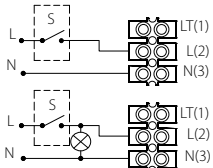

Quiet-Hex 100 Duo V (2 speed)

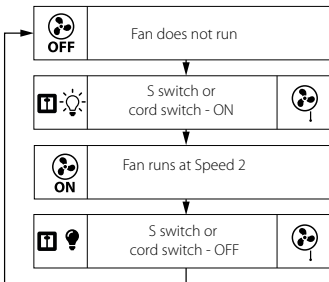
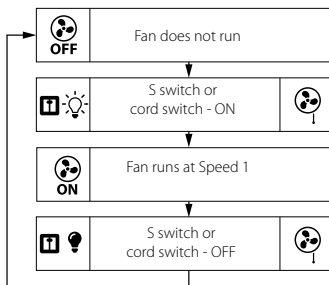
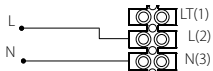

Quiet-Hex 100 Duo (1 and 2 speed)

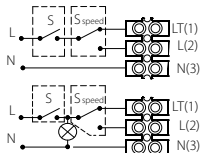

Quiet-Hex 100 Duo V (1 and 2 speed)

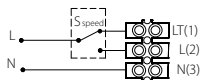

1 and 2 speed

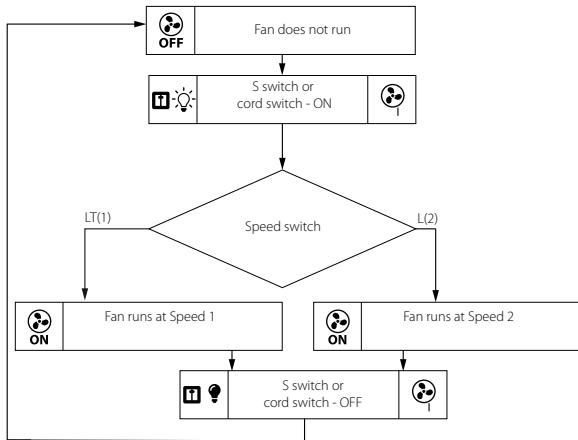

Quiet-Hex 100 Duo T

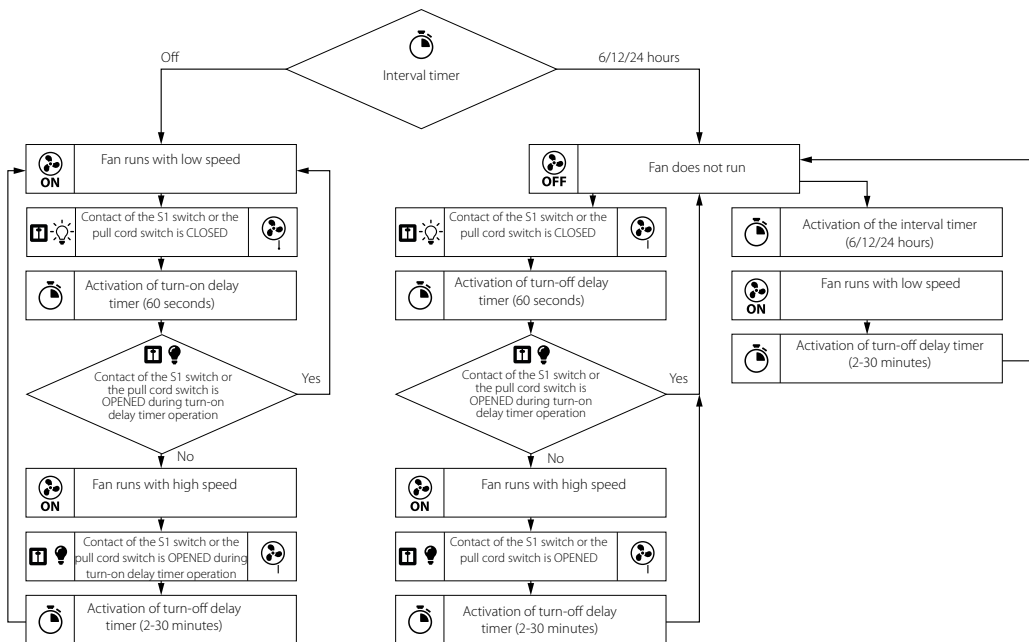
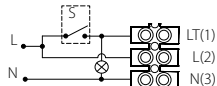
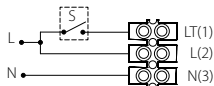

Quiet-Hex 100 Duo TH

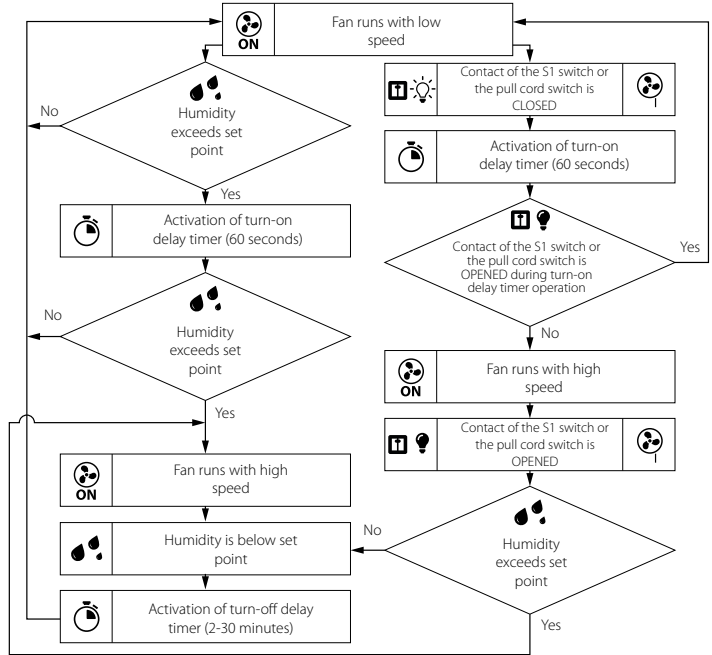
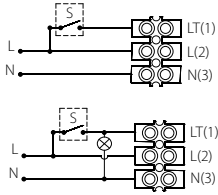

MAINTENANCE

The fan maintenance periodicity is at least once per 6 months.

Maintenance steps:

- disconnect the fan from power supply and make sure electricity has been turned off;
- remove the front panel, wipe the fan with a dry cloth or a brush;
- wash the front panel under running water;
- wipe the fan surfaces dry;
- cover the fan with the front panel;
- connect power supply to the fan.

WARNING! Do not allow water or liquid come into contact with electric components!

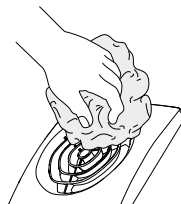
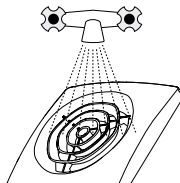
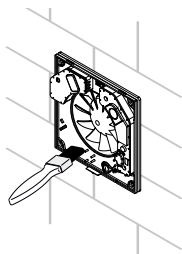
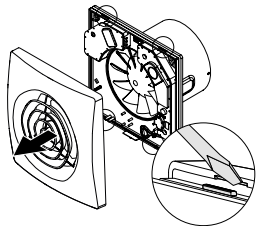

TROUBLESHOOTING

Problem	Possible reasons	Troubleshooting
When the unit is connected to power mains, the fan does not rotate and does not respond to any controls.	No power supply.	Make sure the power supply line is connected correctly, otherwise troubleshoot a connection error.
	Internal connection fault.	Contact the Seller.
Low air flow.	The ventilation system is clogged.	Clean the ventilation system.
Increased noise, vibration.	The impeller is clogged.	Clean the impeller.
	The fan is not secured well or is not mounted properly.	Troubleshoot the installation error.
	The ventilation system is clogged.	Clean the ventilation system.

STORAGE AND TRANSPORTATION REGULATIONS

- Store the unit in the manufacturer's original packaging box in a dry closed ventilated premise with temperature range from +5 °C to + 40 °C and relative humidity up to 70 %.
- Storage environment must not contain aggressive vapors and chemical mixtures provoking corrosion, insulation, and sealing deformation.
- Use suitable hoist machinery for handling and storage operations to prevent possible damage to the unit.
- Follow the handling requirements applicable for the particular type of cargo.
- The unit can be carried in the original packaging by any mode of transport provided proper protection against precipitation and mechanical damage. The unit must be transported only in the working position.
- Avoid sharp blows, scratches, or rough handling during loading and unloading.
- Prior to the initial power-up after transportation at low temperatures, allow the unit to warm up at operating temperature for at least 3-4 hours.

MANUFACTURER'S WARRANTY

The product is in compliance with EU norms and standards on low voltage guidelines and electromagnetic compatibility. We hereby declare that the product complies with the provisions of Electromagnetic Compatibility (EMC) Directive 2014/30/EU of the European Parliament and of the Council, Low Voltage Directive (LVD) 2014/35/EU of the European Parliament and of the Council and CE-marking Council Directive 93/68/EEC. This certificate is issued following test carried out on samples of the product referred to above.

The manufacturer hereby warrants normal operation of the unit for 24 months after the retail sale date provided the user's observance of the transportation, storage, installation, and operation regulations. Should any malfunctions occur in the course of the unit operation through the Manufacturer's fault during the guaranteed period of operation, the user is entitled to get all the faults eliminated by the manufacturer by means of warranty repair at the factory free of charge. The warranty repair includes work specific to elimination of faults in the unit operation to ensure its intended use by the user within the guaranteed period of operation. The faults are eliminated by means of replacement or repair of the unit components or a specific part of such unit component.

The warranty repair does not include:

- routine technical maintenance
- unit installation/dismantling
- unit setup

To benefit from warranty repair, the user must provide the unit, the user's manual with the purchase date stamp, and the payment paperwork certifying the purchase. The unit model must comply with the one stated in the user's manual. Contact the Seller for warranty service.

The manufacturer's warranty does not apply to the following cases:

- User's failure to submit the unit with the entire delivery package as stated in the user's manual including submission with missing component parts previously dismantled by the user.
- Mismatch of the unit model and the brand name with the information stated on the unit packaging and in the user's manual.
- User's failure to ensure timely technical maintenance of the unit.
- External damage to the unit casing (excluding external modifications as required for installation) and internal components caused by the user.
- Redesign or engineering changes to the unit.

- Replacement and use of any assemblies, parts and components not approved by the manufacturer.
- Unit misuse.
- Violation of the unit installation regulations by the user.
- Violation of the unit control regulations by the user.
- Unit connection to power mains with a voltage different from the one stated in the user's manual.
- Unit breakdown due to voltage surges in power mains.
- Discretionary repair of the unit by the user.
- Unit repair by any persons without the manufacturer's authorization.
- Expiration of the unit warranty period.
- Violation of the unit transportation regulations by the user.
- Violation of the unit storage regulations by the user.
- Wrongful actions against the unit committed by third parties.
- Unit breakdown due to circumstances of insuperable force (fire, flood, earthquake, war, hostilities of any kind, blockades).
- Missing seals if provided by the user's manual.
- Failure to submit the user's manual with the unit purchase date stamp.
- Missing payment paperwork certifying the unit purchase.



FOLLOWING THE REGULATIONS STIPULATED HEREIN WILL ENSURE A LONG AND TROUBLE-FREE OPERATION OF THE UNIT



USER'S WARRANTY CLAIMS SHALL BE SUBJECT TO REVIEW ONLY UPON PRESENTATION OF THE UNIT, THE PAYMENT DOCUMENT AND THE USER'S MANUAL WITH THE PURCHASE DATE STAMP



Quality Inspector's Stamp

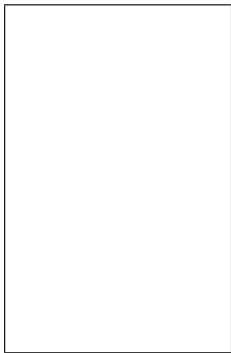

Sold by
(name and stamp of the seller)



Manufacture Date

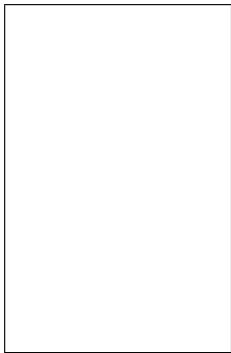

Purchase Date



Certificate of acceptance

Quiet-Hex _____

The fan is recognized as serviceable.