

VK 100 Duo



Inline centrifugal fans in plastic casing

- Maximum airflow: 264
- Sound pressure level LpA at 3 m: 38
- Motor type: AC
- Impeller type: Centrifugal backward curved blades
- Casing material: Plastic
- Installation in any position

	Unit of measurement	VK 100 Duo	
Connected air duct size	mm	100	
Speed	-	2	
Minimum supply voltage	V	230	
Maximum supply voltage	V	230	
Power supply frequency	Hz	50	
Rated power	W	45	57
Unit current	A	0.21	0.25
Maximum airflow	m ³ /h	157	264
Sound pressure level LpA at 3 m	dB(A)	29	38
Weight	kg	2.01	
Transported air temperature (max)	°C	55	
Transported air temperature (min)	°C	-25	
Ingress protection rating	-	IPX4	

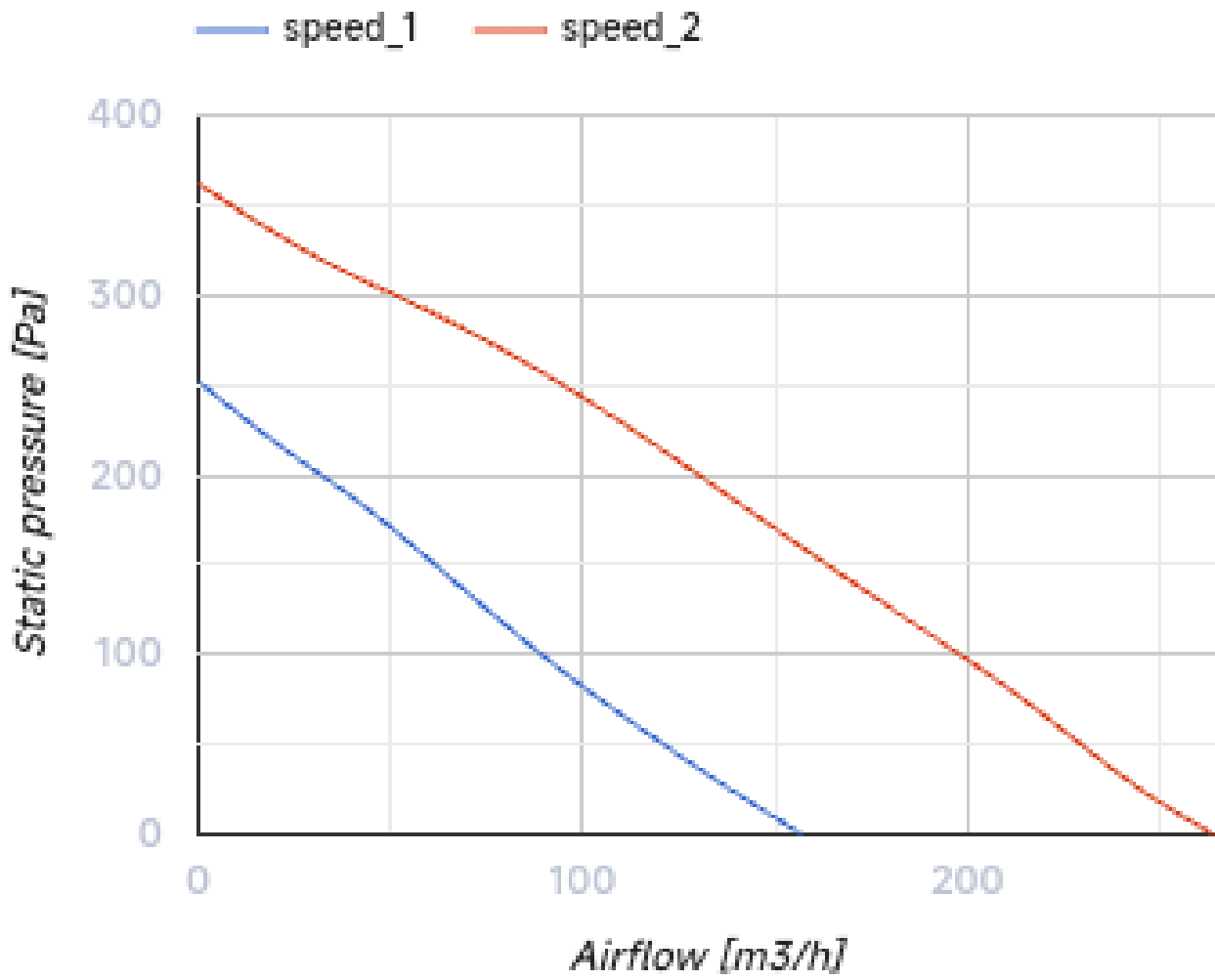

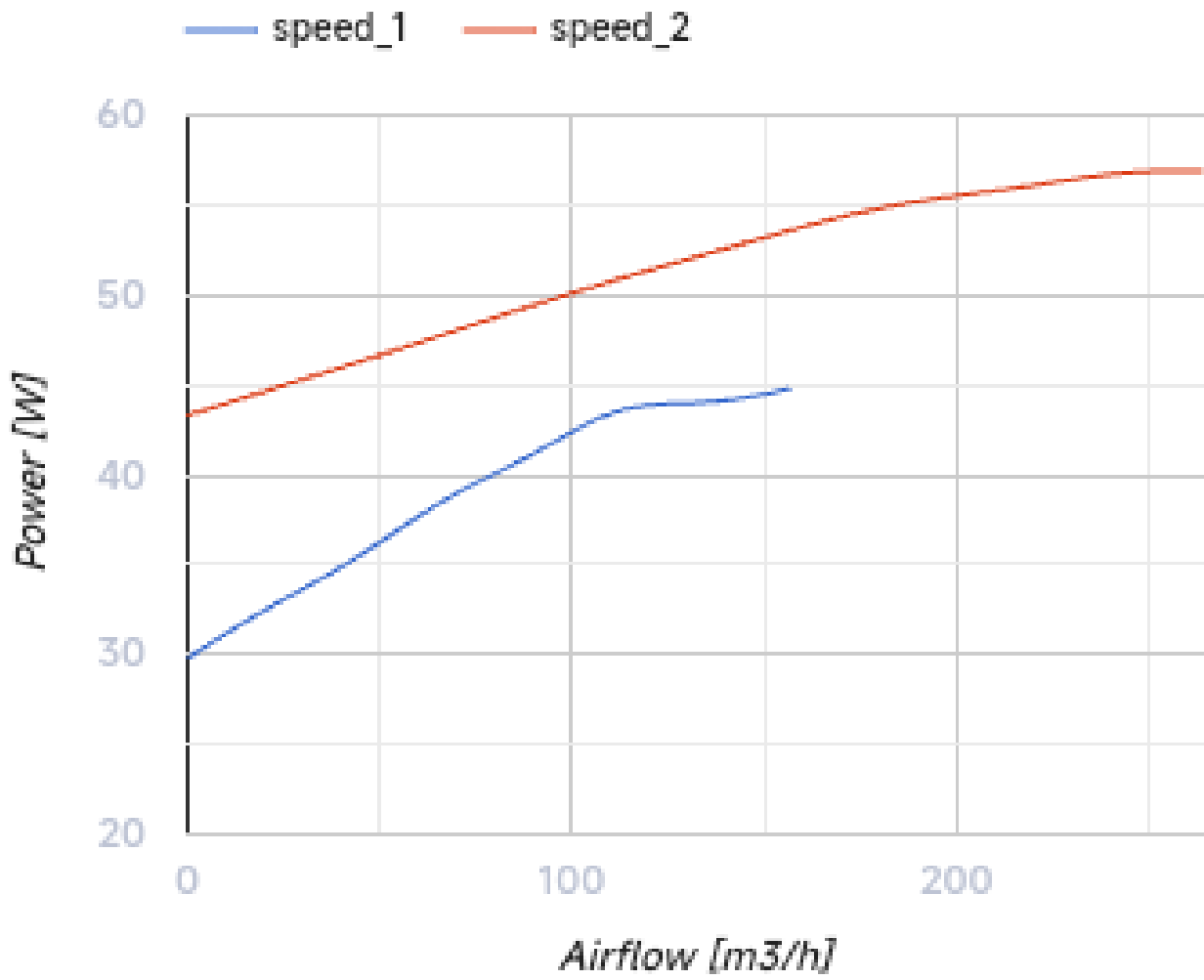

Dimensions

ØD	ØD1	B	L	L1	L2	L3
100	250	270	230	30	27	30

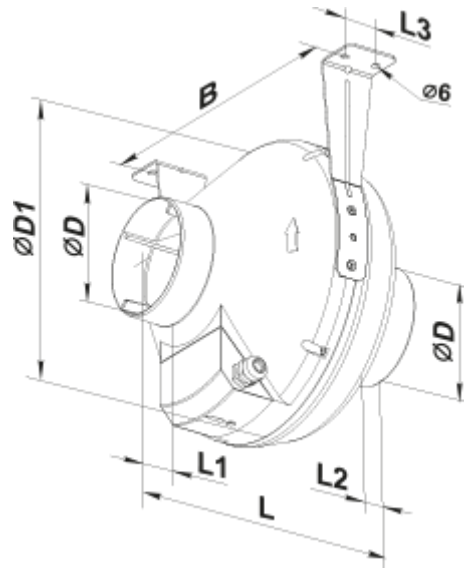

Ecodesign

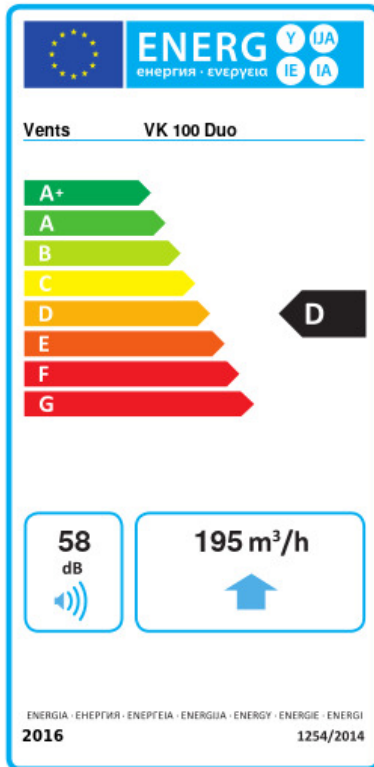

Trademark	Vents					
Model	VK 100 Duo					
Specific energy consumption (SEC) (kWh/(m ² /a))	Cold		Average		Warm	
	-49.3	A+	-22.2	D	-6.7	F
Type of ventilation unit	Unidirectional					
Type of drive installed	2-speed					
Type of heat recovery system	None					
Maximum flow rate (m ³ /h)	195					
Electric power input (W)	55.1					
Reference flow rate (m ³ /s)	0.038					
Reference pressure difference (Pa)	50					
Specific power input (SPI) (W/(m ³ /h))	0.326					
Control typology	Local demand control					
Maximum external leakage rates (%)	2.7					
Declared typology	RVU UVU					
Sound power level (dB(A))	58					
The annual electricity consumption (AEC) (kWh/a)	Cold		Average		Warm	
	244		244		244	
The annual heating saved (AHS) (kWh/a)	Cold		Average		Warm	
	5536		2830		1280	