

VK 250 EC



Centrifugal inline fans in plastic casings with EC-motors

- Maximum airflow: 1250
- Sound pressure level LpA at 3 m: 48
- Motor type: EC
- Impeller type: Centrifugal backward curved blades
- Casing material: Polypropylene/Thermoplastic elastomer
- Installation in any position

	Unit of measurement	VK 250 EC
Connected air duct size	mm	250
Speed	-	1
Minimum supply voltage	V	230
Maximum supply voltage	V	230
Power supply frequency	Hz	50/60
Rated power	W	165
Unit current	A	1.1
Maximum airflow	m ³ /h	1250
Sound pressure level LpA at 3 m	dB(A)	48
Weight	kg	4.3
Transported air temperature (max)	°C	60
Transported air temperature (min)	°C	-25
Ingress protection rating	-	IPX4
Ingress protection rating of the drive	-	IP55

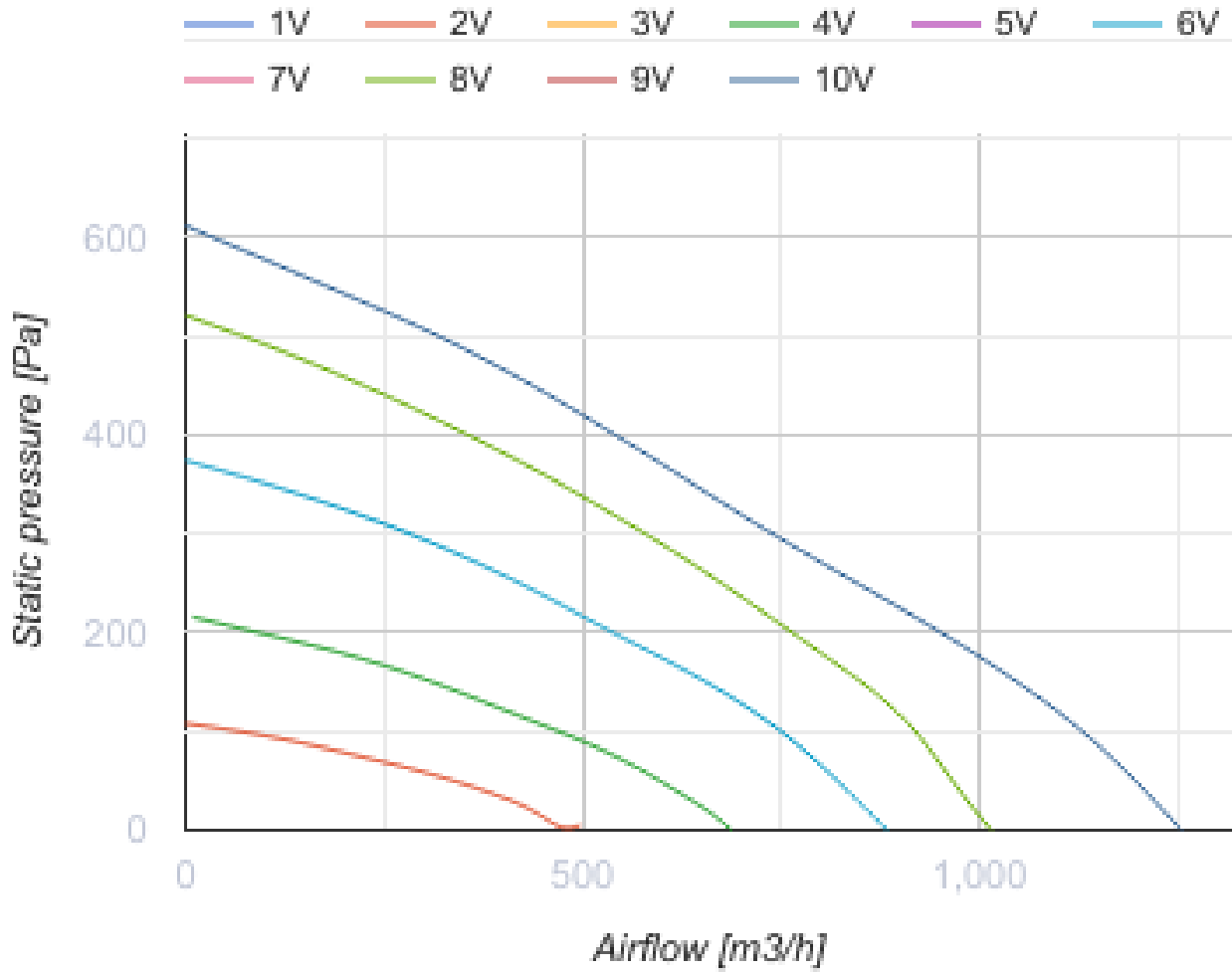

Dimensions

$\varnothing D$	$\varnothing D1$	B	L	L1	L2	L3
250	340	354	265	30	30	40

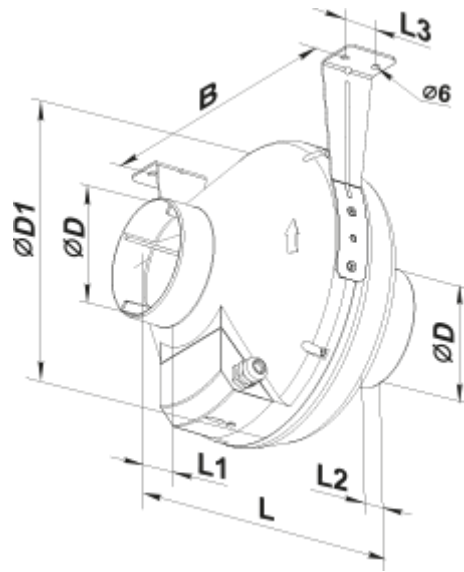

Ecodesign

Trademark	Vents
Model	VK 250 EC
Type of drive installed	Integrated VSD
Type of heat recovery system	None
Nominal flow rate (m ³ /s)	0.082
Nominal external pressure (Pa)	754
Maximum external leakage rates (%)	2.7
Static efficiency (%)	42.2
Declared typology	NRVU UVU
Effective electric power input (kW)	0.17
Sound power level (dB(A))	66