

VK 315 P



Inline centrifugal fans in plastic casing

- Maximum airflow: 1340
- Motor type: AC
- Control: Built-in speed controller
- Impeller type: Centrifugal impeller with backward curved blades
- Casing material: Plastic
- Installation in any position
- Cable with mains plug

	Unit of measurement	VK 315 P
Connected air duct size	mm	315
Speed	-	1
Minimum supply voltage	V	220
Maximum supply voltage	V	240
Power supply frequency	Hz	50/60
Rated power	W	200
Unit current	A	0.88
Maximum airflow	m ³ /h	1340
Weight	kg	4.85
Transported air temperature (max)	°C	50
Transported air temperature (min)	°C	-25
Ingress protection rating	-	IPX4

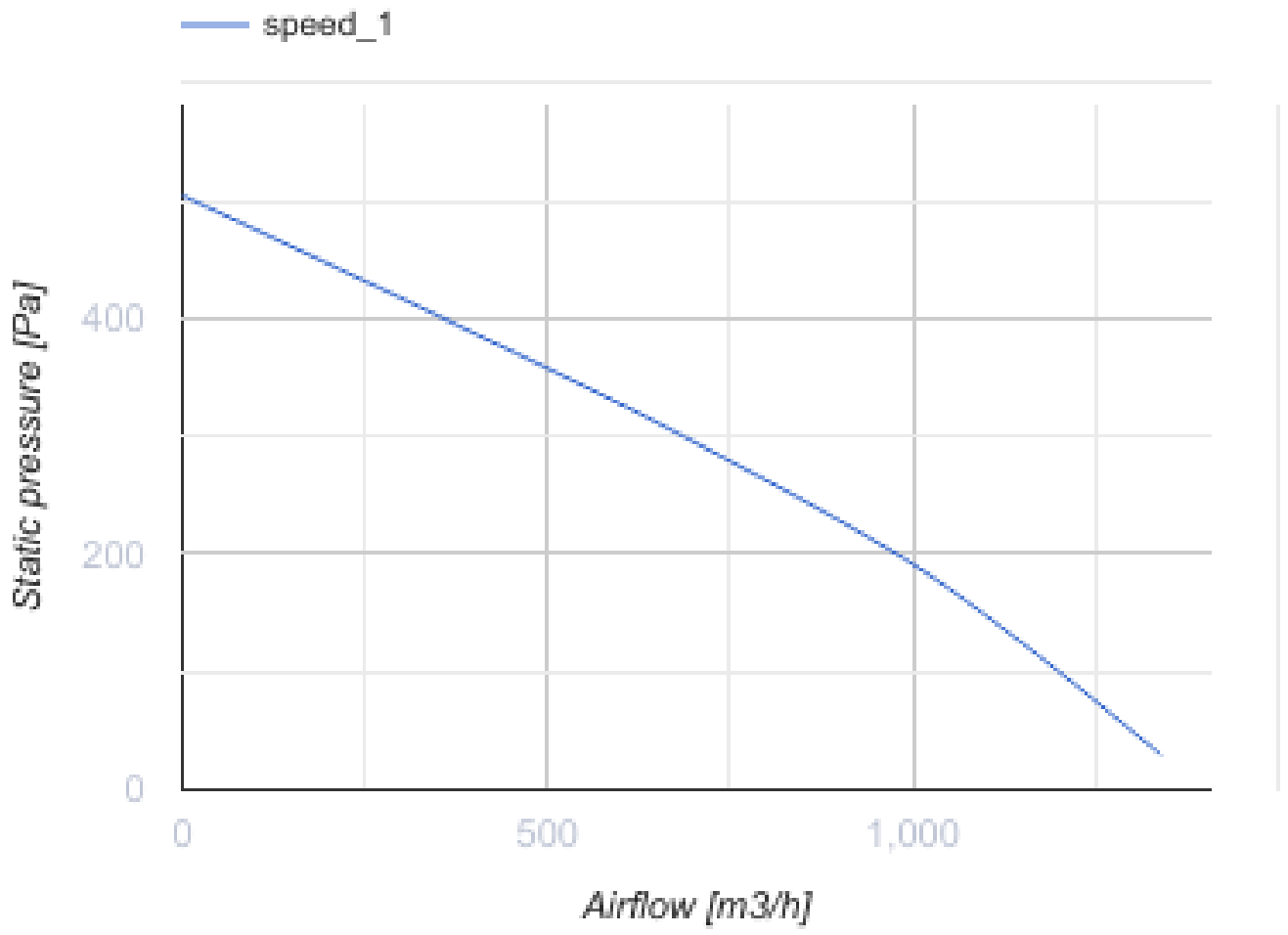

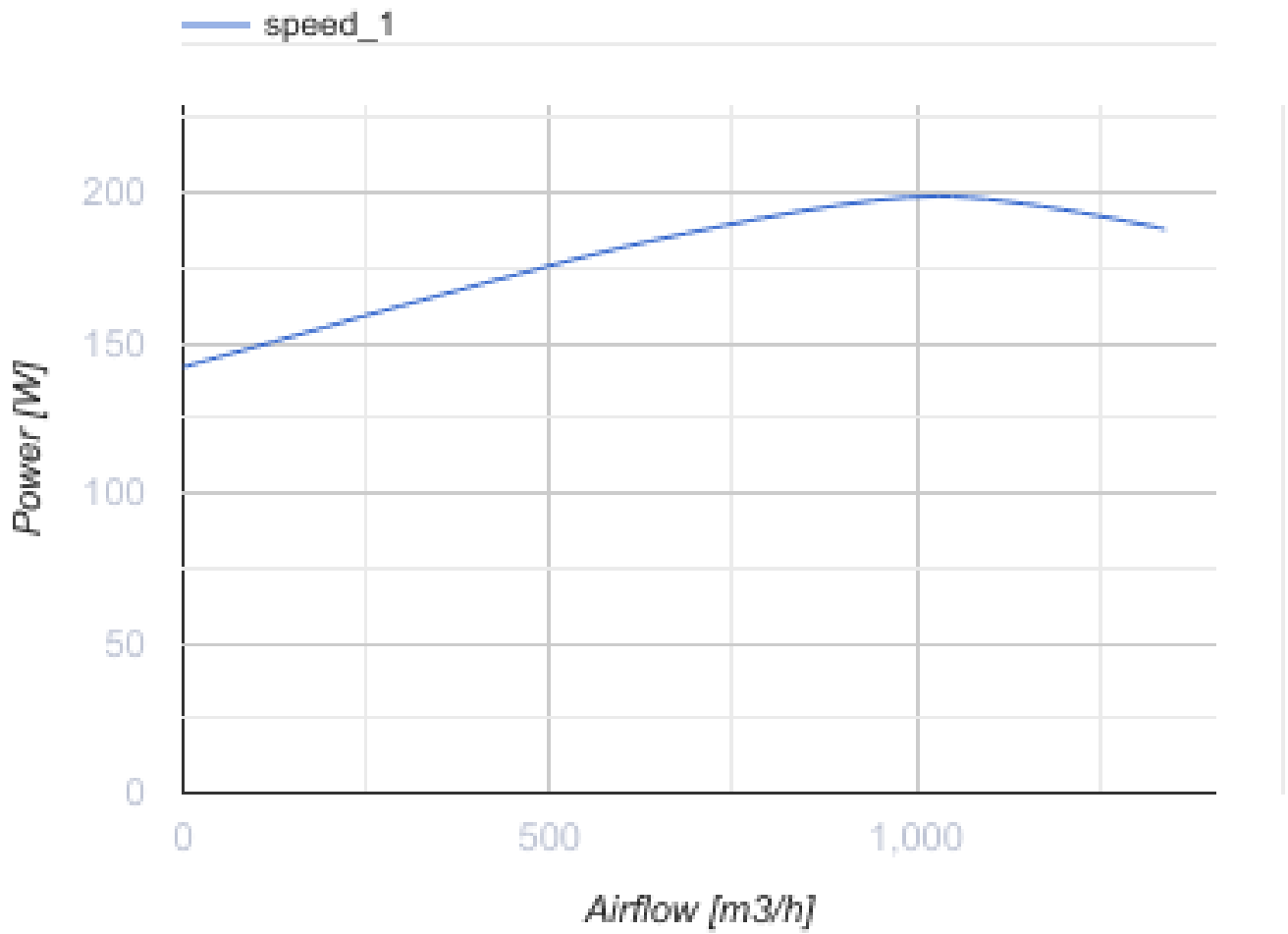

Dimensions

ØD	ØD1	B	L	L1	L2	L3
315	400	414	276	40	55	40

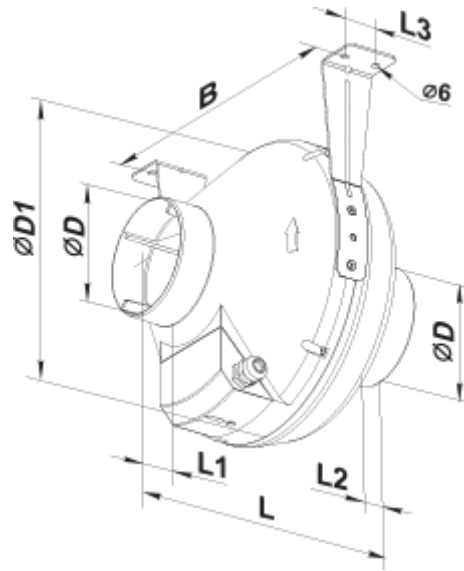

Ecodesign

Trademark	Vents
Model	VK 315 P
Type of drive installed	External MSD or VSD
Type of heat recovery system	None
Nominal flow rate (m ³ /s)	0.242
Nominal external pressure (Pa)	237
Maximum external leakage rates (%)	2.7
Static efficiency (%)	30.2
Effective electric power input (kW)	0.194
Sound power level (dB(A))	70
Declared typology	NRVU UVU