

## VK 315 U



Centrifugal inline fans in plastic casings

- Maximum airflow: 1240
- Sound pressure level LpA at 3 m: 49
- Motor type: AC
- Control: Built-in speed controller
- Impeller type: Centrifugal impeller with backward curved blades
- Casing material: Plastic
- Installation in any position
- Cable with mains plug
- Temperature sensor

	Unit of measurement	VK 315 U	
Connected air duct size	mm	315	
Speed	-	1	
Phases	-	1	
Minimum supply voltage	V	230	
Maximum supply voltage	V	230	
Power supply frequency	Hz	50	60
Rated power	W	169	
Unit current	A	0.74	
Maximum airflow	m <sup>3</sup> /h	1240	
Sound pressure level LpA at 3 m	dB(A)	49	
Weight	kg	4.85	
Transported air temperature (max)	°C	50	
Transported air temperature (min)	°C	-25	
Ingress protection rating	-	IPX4	

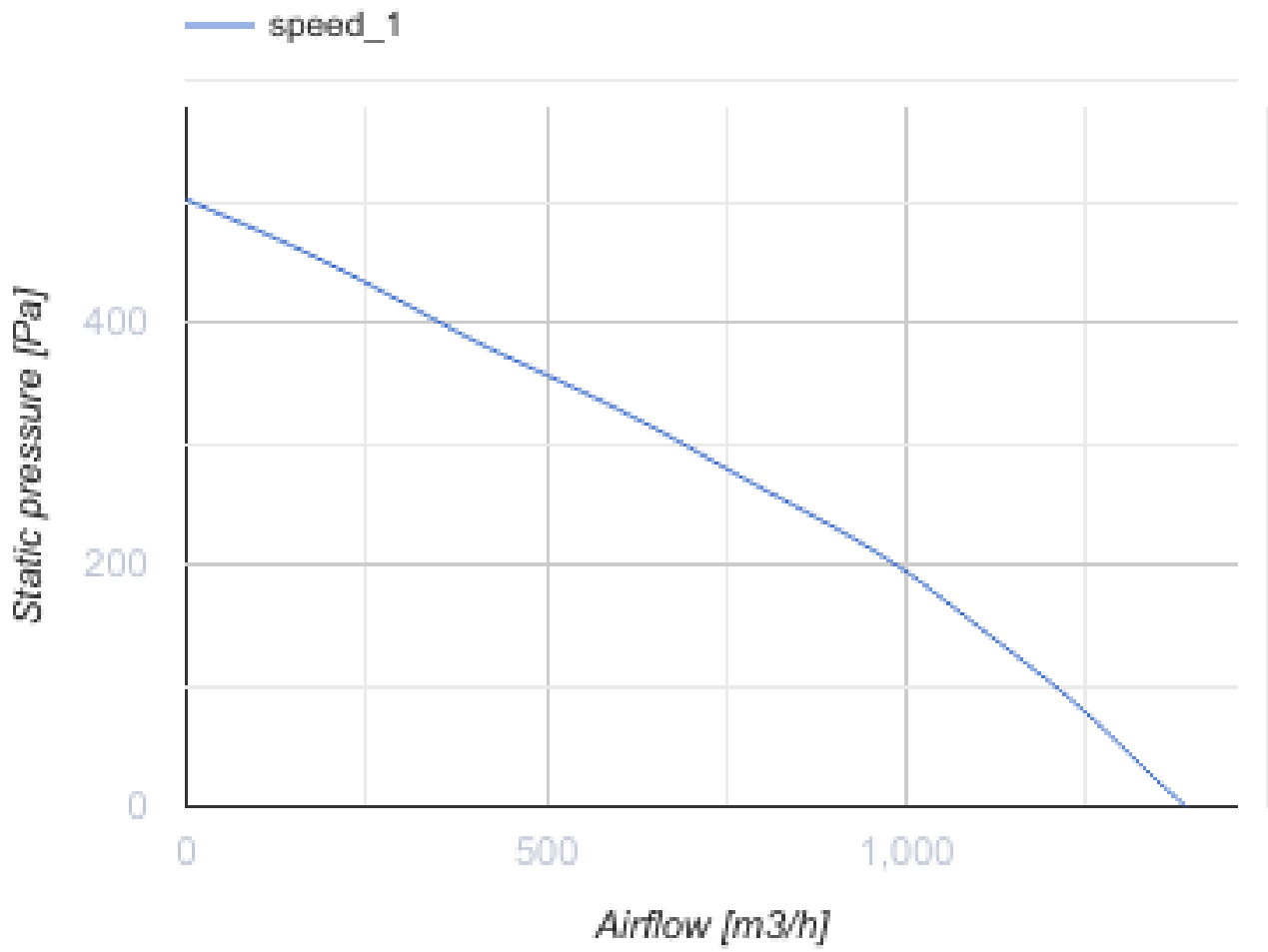

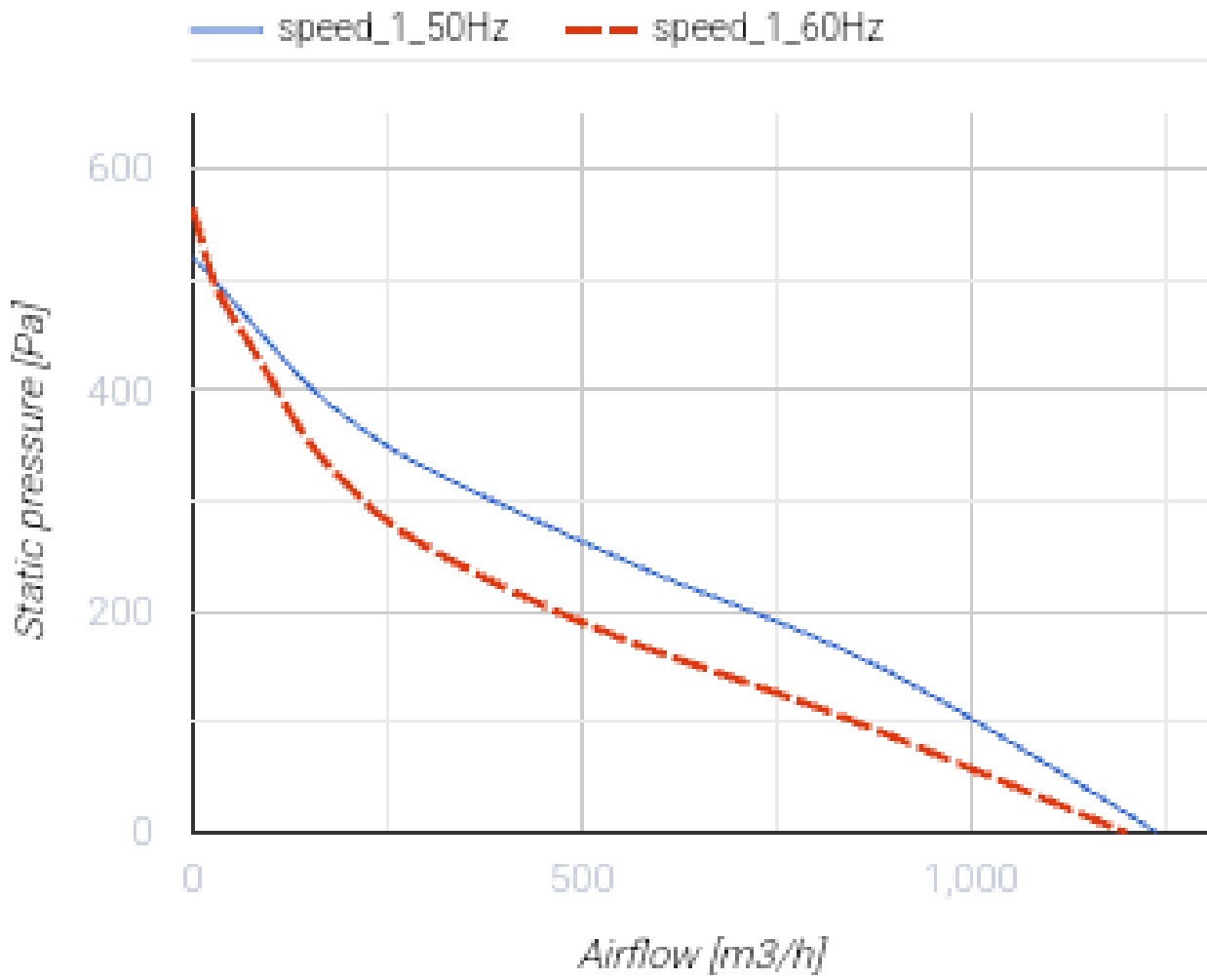

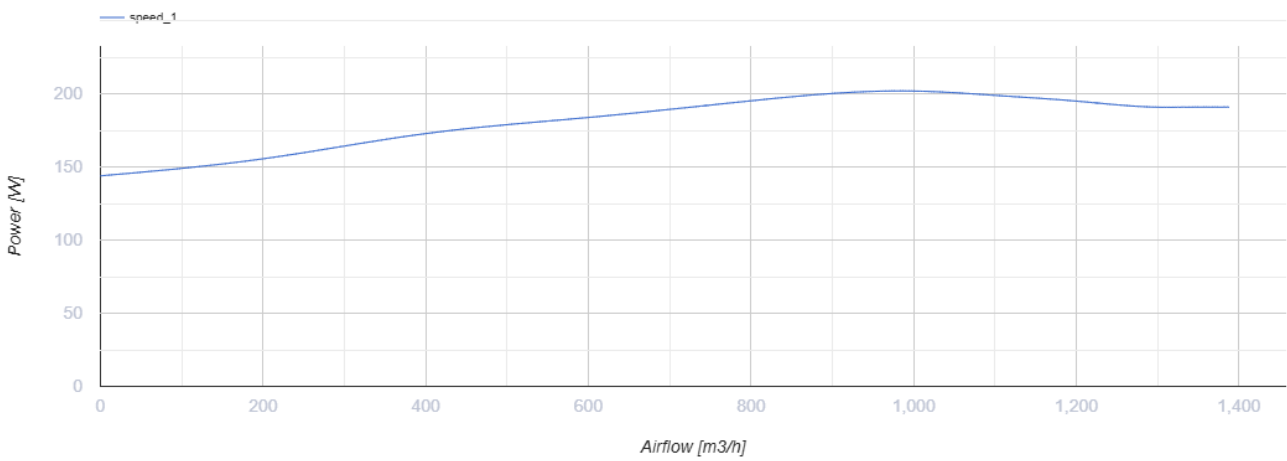
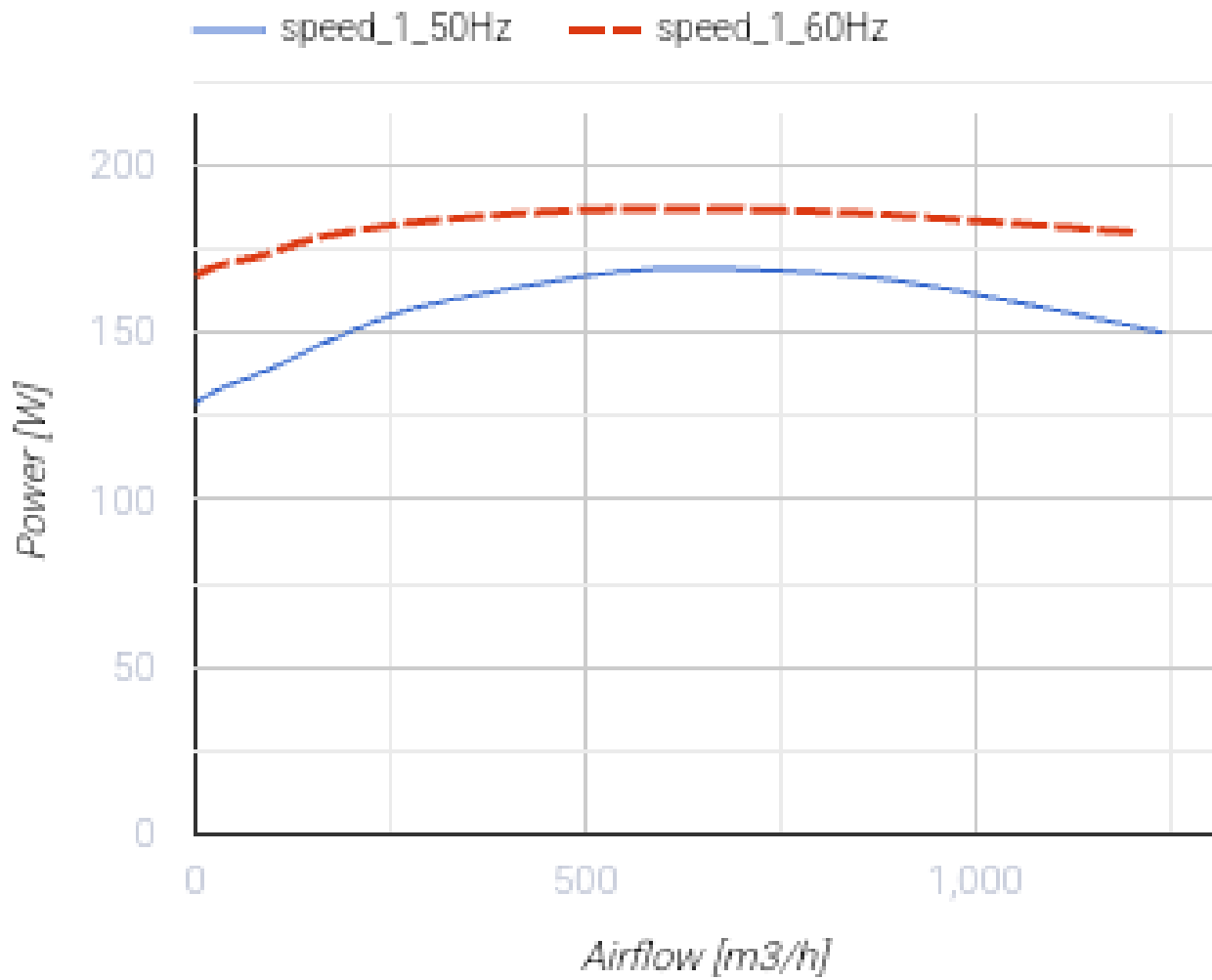

## Dimensions

ØD	ØD1	B	L	L1	L2	L3
315	400	414	276	40	55	40

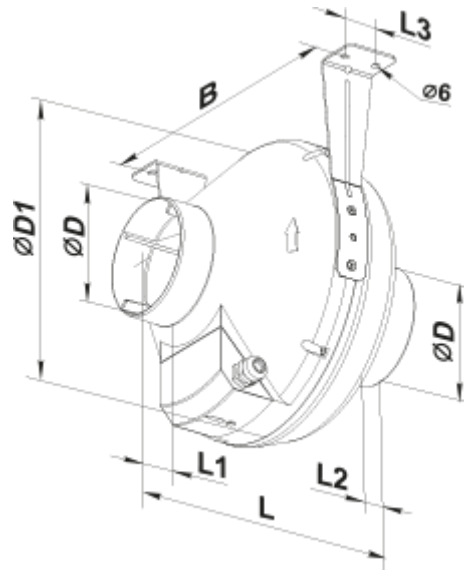

## Ecodesign

Trademark	Vents
Model	VK 315 U
Type of drive installed	External MSD or VSD
Type of heat recovery system	None
Nominal flow rate (m <sup>3</sup> /s)	0.242
Nominal external pressure (Pa)	237
Maximum external leakage rates (%)	2.7
Static efficiency (%)	30.2
Declared typology	NRVU UVU
Effective electric power input (kW)	0.194
Sound power level (dB(A))	70