

VUER 601 VE EC L A21



Vertical air handling units with a sorption rotary heat exchanger

- Power of electrical reheater: 1400
- Maximum airflow: 747
- Sound pressure level LpA at 3 m: 29
- Heat exchanger type: Sorption rotary
- Extract filter: G4 / Coarse > 60%
- Supply filter: G4 / Coarse > 60% (option F7 / ePM1 60%)
- Sound insulation
- Motor type: EC
- Reheater: Built-in
- BMS protocol: ModBus
- Control: Smartphone
- Casing material: Coated steel
- Humidity sensor: Optional
- CO2 sensor: Optional
- VOC sensor: Optional
- PM2.5 sensor: Optional

	Unit of measurement	VUER 601 VE EC L A21
Connected air duct size	mm	200
Speed	-	1
Phases	-	1
Minimum supply voltage	V	230
Maximum supply voltage	V	230
Power supply frequency	Hz	50/60
Rated power	W	336
Power of electrical reheater	W	1400
Unit current	A	8.51
Maximum airflow	m ³ /h	747
Sound pressure level LpA at 3 m	dB(A)	29
Heat recovery efficiency, max	%	86
Heat exchanger type	-	Sorption rotary
Weight	kg	90
Extract filter	-	G4 / Coarse > 60%
Supply filter	-	G4 / Coarse > 60% (option F7 / ePM1 60%)
Transported air temperature (max)	°C	40
Transported air temperature (min)	°C	-25
Ambient air temperature min	°C	1

Ambient air temperature max	°C	40
Ambient air humidity max	%	60
Ingress protection rating	-	IP22
Ingress protection rating of the drive	-	IP44

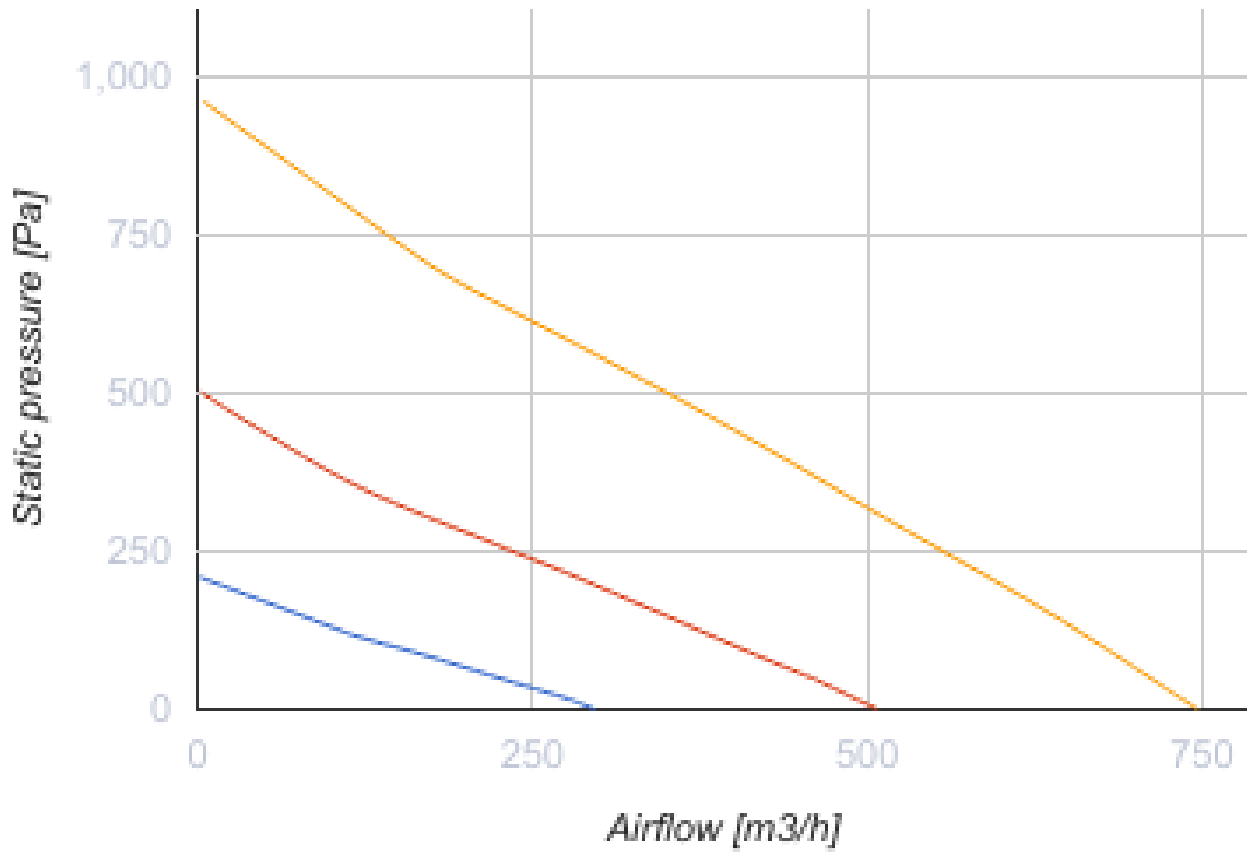

Dimensions

H	W	L	H1	W1	W2	W3	L1	L2	D	D1
750	900	609	828	427	192	140	248	167	200	125

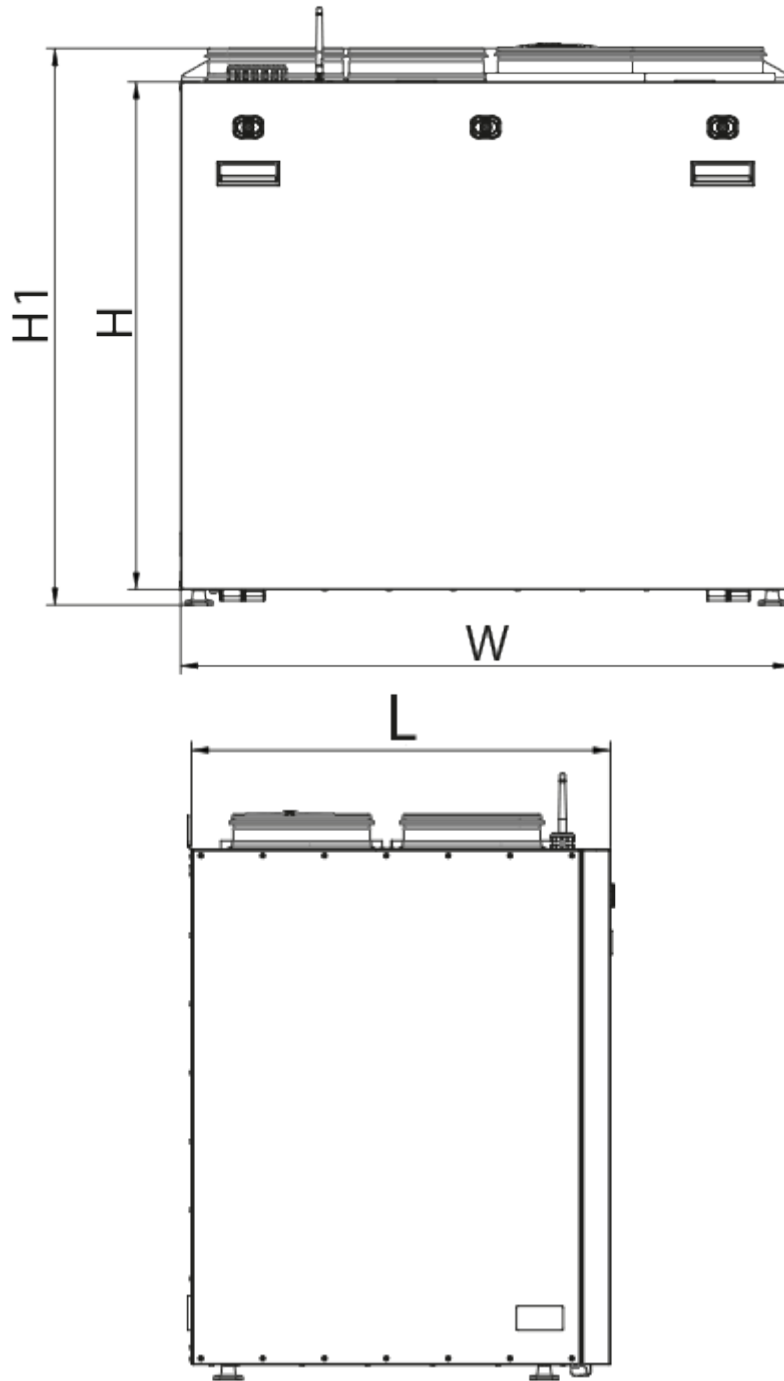

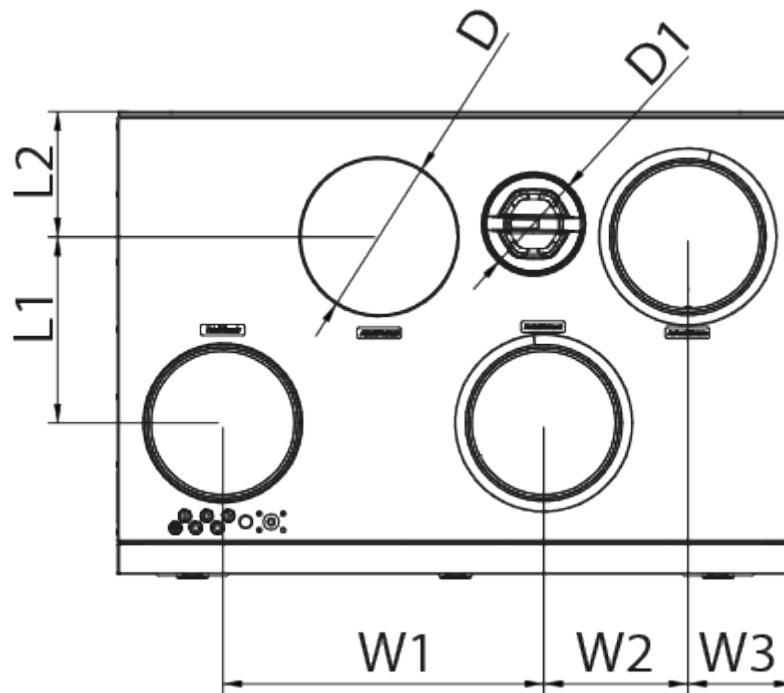

Accessories

Control Panels for AHU



Name	Photo	Description
A25		The control panel with a sensor display
A22		The A22/A22 WiFi control panels are used for control of industrial and domestic air handling units with an A21 automation system.
A22 WiFi		The A22/A22 WiFi control panels are used for control of industrial and domestic air handling units with an A21 automation system.

Sensors

Name	Photo	Description
HV2		Humidity sensor
CO2-3		CO2 sensor
CO2-1		CO2 sensors

HR-S		Electro-mechanical humidistats
----------------------	---	--------------------------------

For round ducts

Name	Photo	Description
SR 200/600		Silencer is applied for noise absorption produced during the ventilating equipment operation and spread along the ducting systems
SR 200/900		Silencer is applied for noise absorption produced during the ventilating equipment operation and spread along the ducting systems
SR 200/1200		Silencer is applied for noise absorption produced during the ventilating equipment operation and spread along the ducting systems



For round ducts

Name	Photo	Description
KRV 200		Air damper for air flow cut-off in round air ducts

Electric actuators

Name	Photo	Description
Belimo TF230		The actuators are designed for controlling air dampers with cross section up to 0.4 m ² performing protection functions

Other accessories

Name	Photo	Description
SF 522x240x48 Coarse 90% G4		Panel filter G4
SF 522x240x40 ePM1 60% F7		F7 panel filter