

# Centrifugal fan VENTS CF



2011

*Fresh air in  
your house!*

## VENTS CF3 Series



Centrifugal fans for exhaust ventilation with the capacity up to 90 m<sup>3</sup>/h.

### Applications

- Continuous or periodic exhaust ventilation of bathroom, showers, kitchens and other utility spaces.
- Ventilation shaft mounting or duct connection.
- Designed for high-resistance ventilation duct systems.
- Compatible with 100 mm air ducts.

### Design

- Modern design and aesthetic look.
- The casing and the impeller are made of high-quality durable ABS plastic, UV resistant.
- The easy to use removable grille with a filter element protects the fan internal components against grease and dust penetration and makes it suitable for kitchen exhaust ventilation.
- The basic CF3 fan modification includes a dust filter. Aluminium grease filter configurations are also available (CFA3 model).
- The centrifugal fan impeller has forward-curved blades for high pressure and low noise levels.
- Equipped with a gravitational backdraft damper for air back flow prevention.
- Protection rating IP 24.

### Motor

- Reliable and low-watt single-phase three-speed electric motor.
- Motor equipped with ball bearings mounted on specially designed vibration dampers.
- Designed for continuous operation and requires no maintenance.
- Equipped with overheating protection.

### Modifications and Options

**CFA3** – fan with an aluminium grease filter

**CF3 P3** – fan with a three speed switch.

### Control

#### Manual:

- The fan is controlled by the speed switch P3-1-300 delivered as a standard (**CF3 P3** model).

#### Automatic:

- By the electronic control unit **BU-1-60** (see Electrical Accessories). The control unit is supplied separately.

### Mounting features

- Suitable for external or built-in mounting.
- Flexible duct application is recommended in case of remote location of the ventilation shaft. The air duct is connected to the fan exhaust flange through a clamp.
- Fixed to the wall by self-tapping screws or fixing brackets.
- Suitable for ceiling mounting.

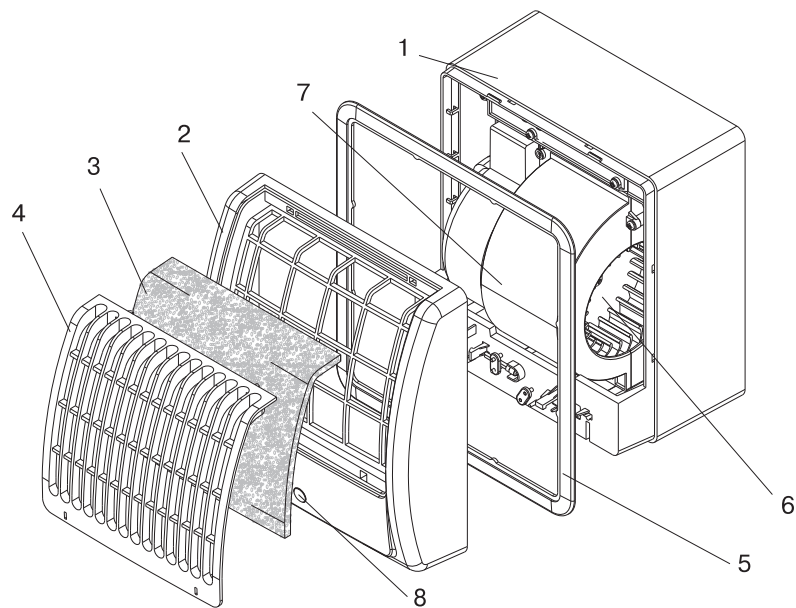

- |                    |           |                     |                  |
|--------------------|-----------|---------------------|------------------|
| 1. Casing          | 3. Filter | 5. Decorative frame | 7. Scroll casing |
| 2. Removable cover | 4. Grille | 6. Impeller         | 8. Light         |

### Aerodynamic characteristics

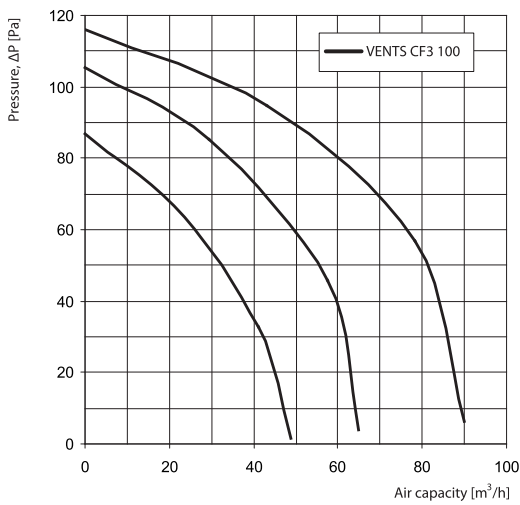

### Overall dimensions

Model	Dimensions [mm]						
	Ø D	B	H	L	L1	L2	L3
VENTS CF 100	100	180	195	132	59	73	26

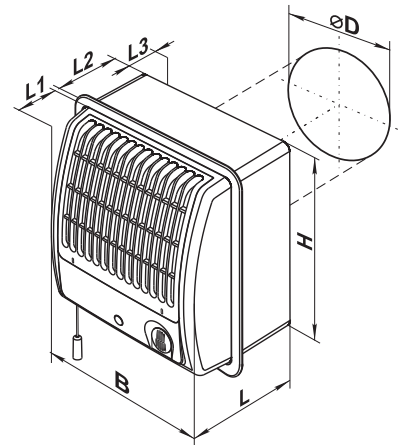

### Technical data

Model	Voltage [V] at 50 Hz	Power Consumption [W]	Current [A]	r.p.m.	Maximum air capacity [m³/h]	Sound Pressure Level at 3m [dB(A)]	Weight [kg]
VENTS CF3 100	1 speed	220-240	11	0,07	825	48	25
	2 speed	220-240	14	0,09	1010	65	31
	3 speed	220-240	21	0,13	1593	90	34

### Mounting examples



Wall surface mounting



Wall flush mounting

### Certificates



The fans meet the applicable safety and electromagnetic compatibility standards.

**VENTILATION SYSTEM**  
[www.ventilation-system.com](http://www.ventilation-system.com)

centrifugal fan VENTS CF

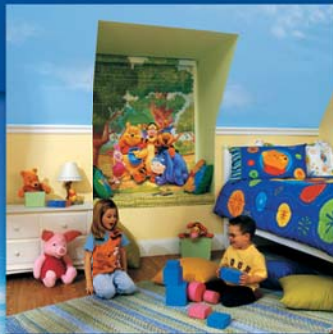

**VENTS reserves the rights to modify any of its products' features, designs, components and specifications at any time and without notice to maintain the development and quality of manufactured goods.**